

10.7 - RACCORDI IN PVDF - PN 16 PER SALDATURA TESTA - TESTA

CARTELLA

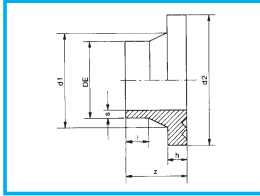

Cod.: RPVDFCAR ...¹⁾

DE ¹⁾	d1	d2	Z	H	I	s
20	27	45	50	5.0	31.0	1.9
25	33	58	50	6.5	31.5	1.9
32	40	68	50	7.0	30.0	2.4
40	50	78	50	8.0	27.0	2.4
50	61	88	50	9.0	26.0	2.9
63	75	102	50	10.0	25.0	3.0
75	89	122	50	11.0	25.0	3.6
90	105	138	80	17.0	26.5	4.3
110	125	158	80	18.0	38.0	5.3

CALOTTA

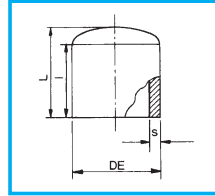

Cod.: RPVDFCAL ...¹⁾

DE ¹⁾	L	I	S
20	45	40	1.9
25	47	40	1.9
32	56	45	2.4
40	63	50	2.4
50	72	55	2.9
63	83	63	3.6
75	95	72	4.3
90	106	87	5.1
110	122	91	6.3

CURVA 90°

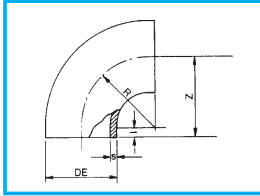

Cod.: RPVDFGOM ...¹⁾

DE ¹⁾	Z	I	R	S
20	26 ± 1	6	20	1.9
25	30 ± 1	5	25	1.9
32	37 ± 1	5	32	2.4
40	45 ± 1	5	40	2.4
50	60 ± 1	10	50	2.9
63	75 ± 1	12	63	3.0
75	90 ± 1	15	75	3.6
90	100 ± 1	10	90	4.3
110	125 ± 1	15	110	5.3

NIPPLO DI PASSAGGIO

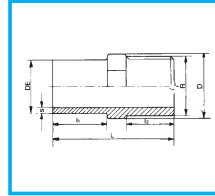

Cod.: RPVDFNIP ...¹⁾

DE ¹⁾	L	11	12	D	R	S
20	46.0	20	18	24.0	1/2"	1.9
25	51.0	23	20	29.5	3/4"	1.9
32	51.0	23	20	39.5	1"	2.4
40	66.0	29	27	50.0	1 1/4"	2.4
50	74.0	33	29	60.0	1 1/2"	2.9
63	80.0	35	31	71.0	2"	3.0

T A 90°

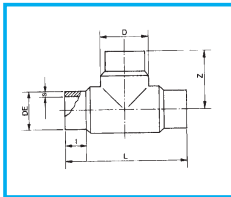

Cod.: RPVDFTIM ...¹⁾

DE ¹⁾	L	Z	I	D	s
20	52	26	10	22	1.9
25	60	30	11	28	1.9
32	74	37	13	36	2.4
40	90	54	13	45	2.4
50	120	60	24	55	2.9
63	150	75	30	69	3.0
75	180	90	30	82	3.6
90	200	100	30	98	4.3
110	242	121	45	120	5.3

ADATTATORE DI PASSAGGIO

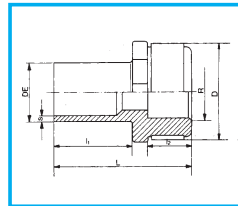

Cod.: RPVDFADP ...¹⁾

DE ¹⁾	L	11	12	D	R	s
20	46.5	26.0	15.0	34	1/2"	1.9
25	51.5	30.0	19.0	44	3/4"	1.9
32	61.1	35.0	20.0	49	1"	2.4
40	65.0	35.0	22.5	60	1 1/4"	2.4
50	74.0	40.0	24.0	73	1 1/2"	2.9
63	77.5	42.0	27.5	95	2"	3.0

Le misure non indicate sono espresse in mm

BOCCHETTONE

Cod.: RPVDFBOC ...¹⁾

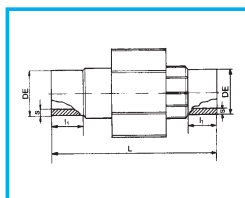

DE ¹⁾	L	11	D	s
20	105	17	48	1.9
25	112	17	53	1.9
32	116	19	62	2.4
40	124	22	73	2.4
50	130	22	86	2.9
63	137	23	104	3.0

RIDUZIONE CONCENTRICA

Cod.: RPVDFRIC ...¹⁾ ...²⁾

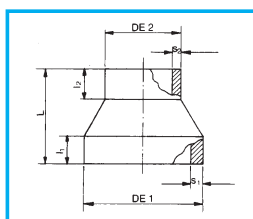

DE1 ¹⁾	DE2 ²⁾	L	11	12	s1	s2
25	20	17.5	7	6	1.9	1.9
32	20	24.5	8	6	2.4	1.9
32	25	21.0	8	7	2.4	1.9
40	20	33.5	10	6	2.4	1.9
40	25	30.0	10	7	2.4	1.9
40	32	25.0	10	8	2.4	2.4
50	25	41.0	12	7	2.9	1.9
50	32	36.0	12	8	2.9	2.4
50	40	31.0	12	10	2.9	2.4
63	32	51.0	16	8	3.0	2.4
63	40	46.0	16	10	3.0	2.4
63	50	39.5	16	12	3.0	2.9
75	40	59.3	19	10	3.6	2.4
75	50	52.7	19	12	3.6	2.9
75	63	45.4	19	16	3.6	3.0
90	50	68.0	22	12	4.3	2.9
90	63	74.0	22	16	4.3	3.0
90	75	54.0	22	19	4.3	3.6
110	63	84.7	28	16	5.3	3.0
110	75	77.3	28	19	5.3	3.6
110	90	67.3	28	22	5.3	4.3

FERMATUBI

Cod: RM ...¹⁾

Gli originali fermatubi, installabili in posizione orizzontale, verticale ed a soffitto, sicuri anche con tubazione piena.

Consentono la naturale dilatazione della tubazione.

¹⁾ Diametri disponibili: fino a 160 mm

Temperature d'impiego: +10 +90°C

Per tubi tondi e lastre in pvdf vedi sez. 2 - materie plastiche

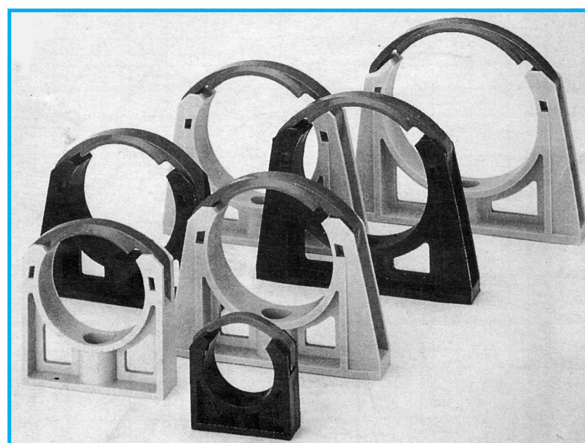

Le misure non indicate sono espresse in mm

10